

EBOR CONCRETES LTD
PO Box 4
Ure Bank Top
Ripon
North Yorkshire
HG4 1JE

T 01765 604351
F 01765 690085
E sales@eborconcrete.co.uk
W www.eborconcrete.co.uk



CLIENTS INCLUDE

- Sainsbury
- IKEA
- Booker
- LIDL
- ASDA
- Somerfield
- L'Oreal
- Parceline
- Royal Mail
- DHL
- Iceland
- Carlsberg
- Holland & Barrett

EBOR

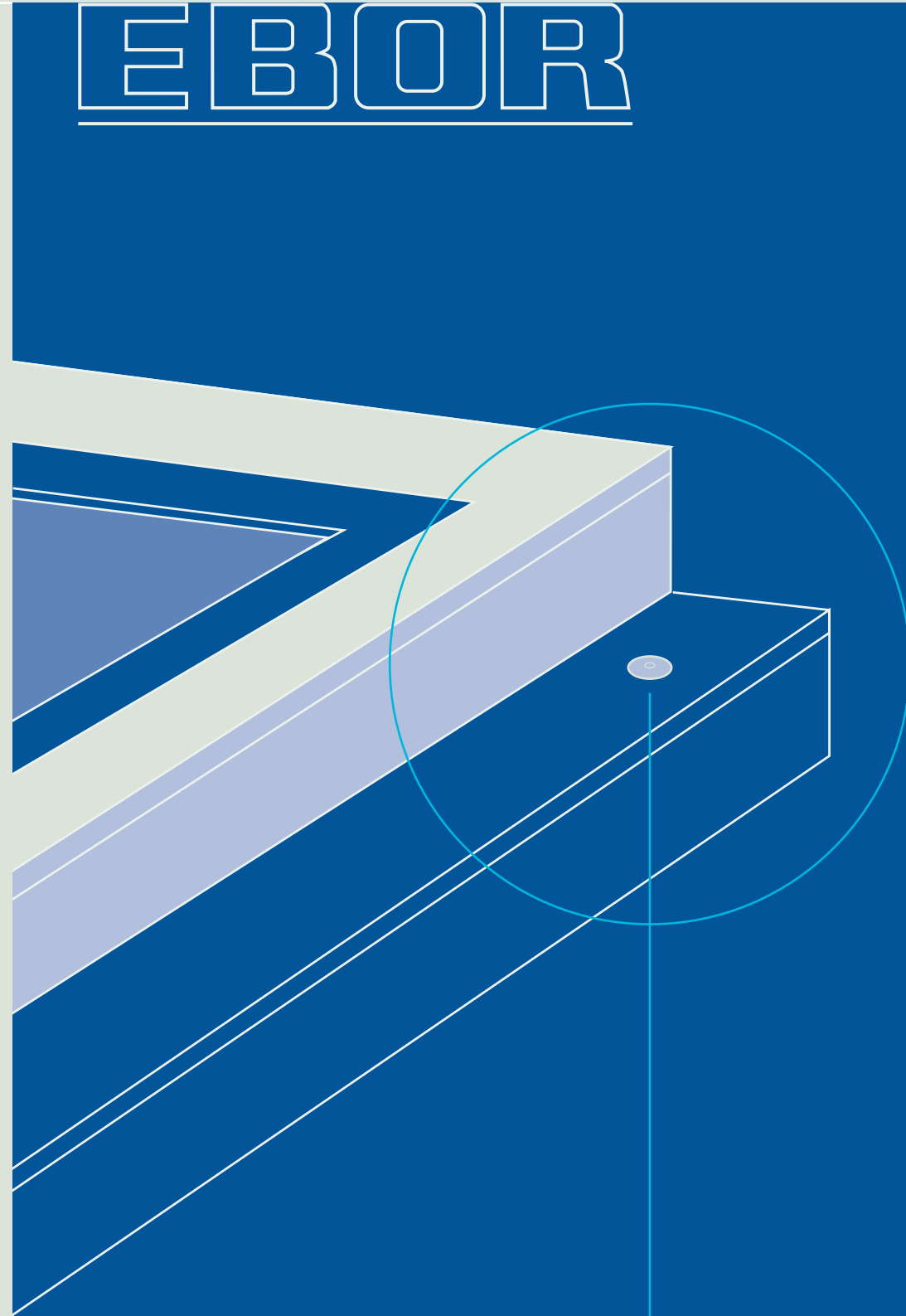

PRECAST CONCRETE
DOCK LEVELLER PITS

Designed & Produced by Aspect +44 (0)1423 501161

EBOR

Ebor Concretes Ltd - Dock Leveller Pits

EBOR'S EXPERTISE

Ebor Concretes is a market leader in the design and manufacture of Dock Leveller Pits. With a skilled workforce and extensive manufacturing facilities, Ebor has the capability to meet the requirements of management and building contractors, constructing nationwide distribution centres.

Decades of experience in the design and manufacture of structural Precast Concrete led to the creation of the Ebor Dock Leveller Pit and Wall Systems. The expertise established during the successful completion of a series of regional distribution centres has enabled Ebor to expand the product range which now offers at least ten options to meet a variety of requirements. With Ebor customers benefiting from short delivery times and cost savings over in-situ concrete, the company is now receiving repeat orders from some of the UK's major retailers.

DESIGN

Dimensional accuracy and quality of manufacture ensure that Ebor Precast Dock Leveller Pits are the preferred choice of Main Contractors. Ebor's engineers prepare all drawings and supporting calculations in accordance with BS8110 for the client's approval prior to manufacture.

LOADING

Standard loading is assumed at 10KN/m² but greater floor loading can be accommodated with suitable modifications. Fully adjustable steel framed moulds allow the designer flexibility and Ebor has extensive experience in creating bespoke applications to meet the architect's specifications.

PROFESSIONAL INDEMNITY

All design work is covered by Ebor's professional indemnity insurance of up to £2 million.

MANUFACTURE

Each pit is manufactured under factory controlled conditions, delivering a degree of dimensional accuracy and consistent standards almost impossible to achieve on site. Quality procedures are followed throughout manufacture with the concrete produced by Ebor using a modern batching plant. A superior surface finish completes this rapid, economical and safe method of construction.

INSTALLATION

Ebor is able to recommend experienced and competent companies to install the Dock Leveller Pits throughout the UK.

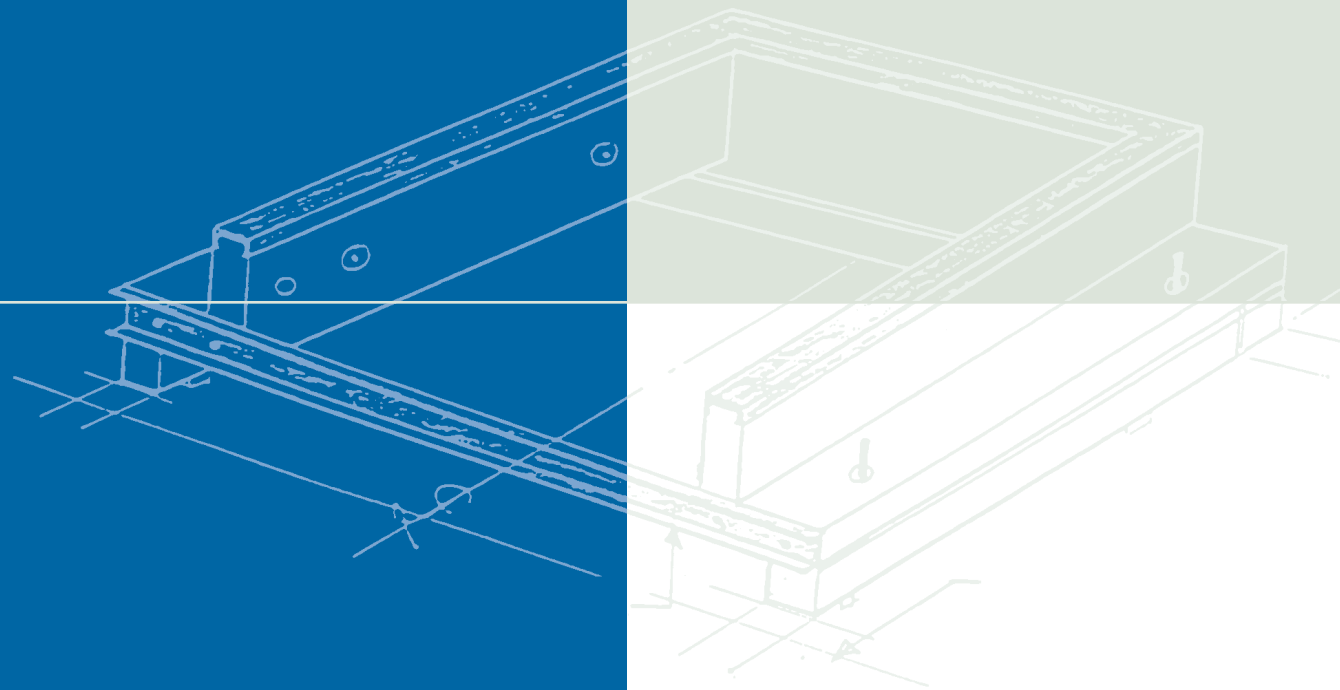

DOCK LEVELLER PITS

DOCK LEVELLER PITS

The traditional practices of constructing dock pits using either in-situ concrete or prefabricated metal pans have experienced major drawbacks, leading to Precast Concrete becoming the preferred choice of Management Contractors.

The Ebor System has been developed in conjunction with a major Dock Leveller manufacturer and a full Design & Build team (specialising in Distribution Centres), to meet the following brief:

- Quicker site completion
- Phased deliveries of components to optimise vital site space
- Accelerated progress of following trades
- Factory tolerances to ensure final fit of the Dock Leveller equipment

The package offered by the Ebor System includes:

- The supply and delivery of Precast Pit Modules (with cast in top protection guards) complete with Dock Wall Units
- Full design service with Ebor engineers preparing all drawing and providing supporting calculations in accordance with BS8110 for approval prior to manufacture
- Method Statement for the erection Sub-Contractor





CLOSED DOCK LEVELLER PITS

EBOR PRECAST CLOSED PITS

Comprise a single module incorporating top protection angles to the walls, suitably rebated to accept the direct fitting of the Dock Leveller Unit.

EBOR PRECAST DOCK/RETAINING WALLS

Choosing the most economical wall profile is primarily dependant upon the Project Engineer's design criteria. Ebor's Design team is able to advise on the most economical solution that will best suit the building layout. (Typical examples figures 1 to 5).

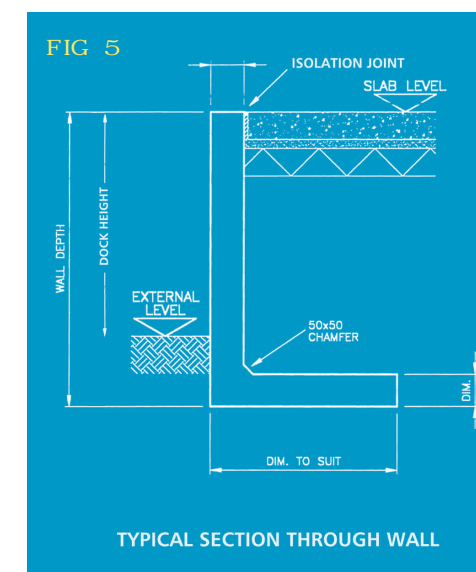
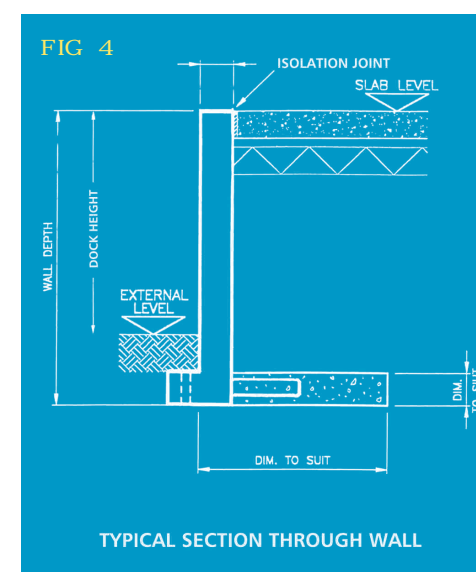
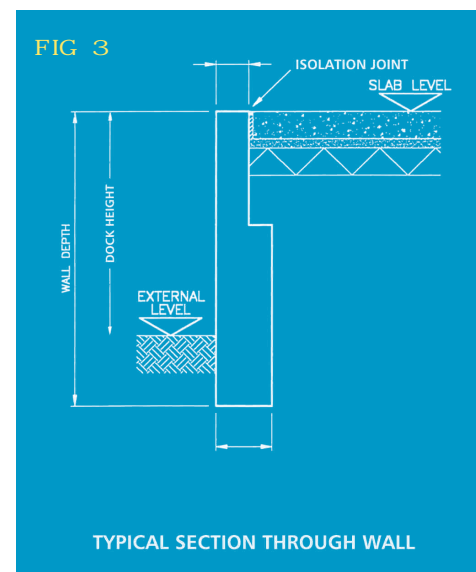
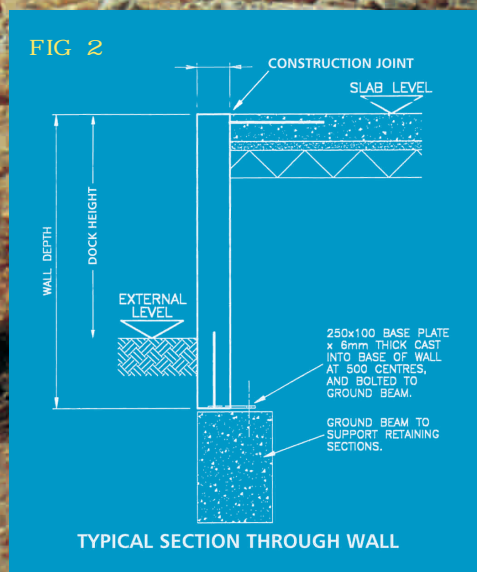
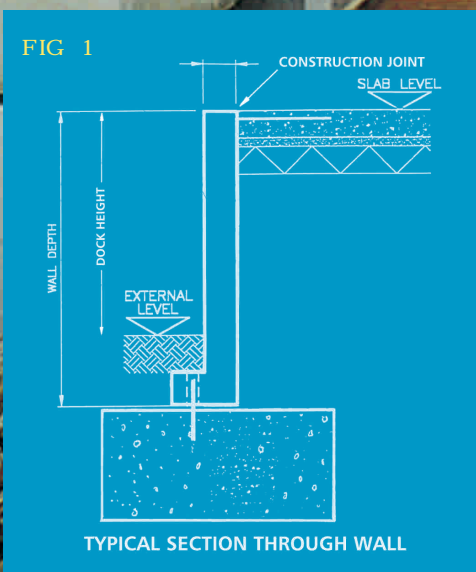

DOCK PIT TOPS, SPECIALLY MODIFIED TO SUIT INSITU SLAB DESIGN/DETAIL

OPEN DOCK LEVELLER PITS



OPEN DOCK LEVELLER PIT (suitable for tailgate vehicles)

Each set comprising:

- 1 No. top section module (approx. wt 3 to 6 tonnes).
- 3 No. plinth units (approx. wt 0.4 to 1 tonne each).
- 2 No. half T front walls (approx. wt 0.5 tonne each). Alternatively 1 No. full T front wall in lieu of the half T walls (approx. wt 1.0 tonne).

The top section module incorporates top protection angles to the walls, suitably rebated to accept the direct fitting of the Dock Leveller Unit. Service holes, box outs cast in fittings and recessed lifting anchors are incorporated to assist with the installation and attaching of the plinths and front walls. All connection cleats, bolts and dowels required to install the pits are included in the price and supplied loose.

TYPICAL ASSEMBLY SEQUENCE OF A DOCK LEVELLER PIT

Ebor arrange phased delivery of components to the location as required to optimise vital site space.

STAGE ONE

Set out the outline of plinth units and dowel positions. Drill holes and grout dowel bars to insitu base. Place and level packing shims.

STAGE TWO

Place into position the 3 No. plinth units, starting with the rear unit.

STAGE THREE

Place packing shims on top of the plinth units (directly above shims underneath plinth unit).

STAGE FOUR

Place top module onto level packs. Check that the top kerb is to line and level - add or remove packs to adjust level before finally grouting up dowel holes. Remove temporary front channel.

STAGE FIVE

Lift into position front T wall pieces, wedge at the bottom to adjust level. Secure to top section of dock pit by corner angle cleat using special T bolts provided to be used in adjustable cast in channels. Finally drill through base plate and corner connection cleats at the rear of the front walls. Grout in dowel pins to the insitu base and fix M16 through bolts to walls and pit module. Finally fill grouting pocket between front wall and pit module.

STAGE SIX

Install dock leveller directly onto rebated protection angles.



STAGE ONE

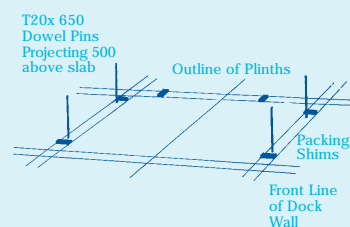

STAGE TWO

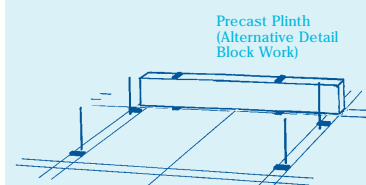

STAGE THREE

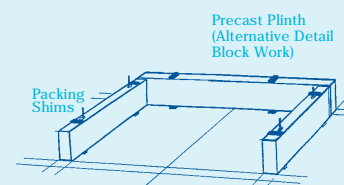

STAGE FOUR

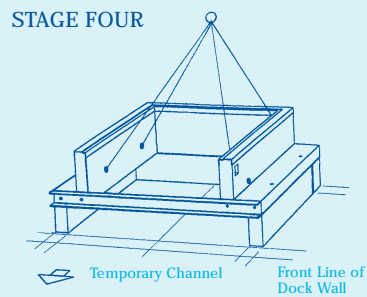

STAGE FIVE

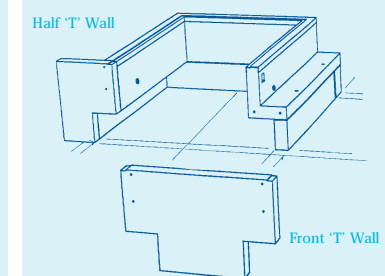

STAGE SIX

